

**NEW**
**Flexible, compact, cleverly designed and for every tanker...**
**... the optimal retrofitting solution, the Bomech UP trailing shoe distributor**

Due to growing demand in the field of retrofitting solutions for smaller tankers and tankers with minimal mounting preparations, which is of course fuelled by the stricter regulations for slurry application in general, Bomech now introduces the Bomech UP trailing shoe distributor.

Experience from our proven professional technology, which has been known and used for years, translated into a perfect retrofit machine with smaller working widths (6 to 10.5m) and a very low dead weight, but still the application quality you are used to from Bomech.



Picture 1: the Bomech UP

### Unequalled ground tracking, because of unique Bomech Field Contour System (FCS)

The unique top feature and heart of the UP series is the newly developed and patented FCS ground tracking system. The system produces unequalled ground tracking in uneven terrain and slopes, even under the most difficult terrain conditions. By means of the FCS system, the trailing shoe distributor can adapt to the ground contour completely free of the tanker movements, in the transverse and longitudinal direction and thus always ensuring optimum slurry placement. Furthermore, the kinematics always generate the optimal angle of the trailing shoes and active pressure on the shoes itself.

Since the Arena macerator is positioned high with regard to the outlets, the transverse distribution is maintained even in the more extreme steep slopes because of the free-fall-principle of the slurry.

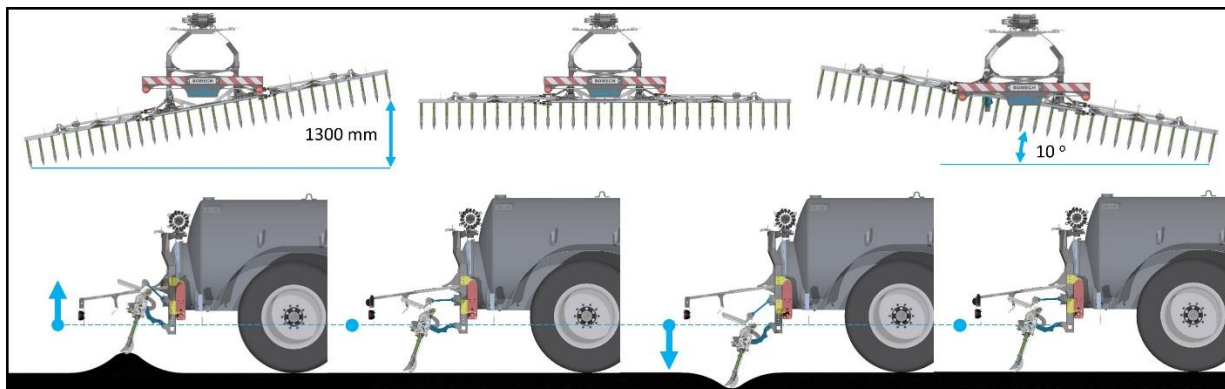

Picture 2: unique Field Contour System (FCS)

### Retrofitting made easy

#everytankerabomech, that is what we always keep in mind and set as our goal when developing new trailing shoe technology. In the development of the UP, we have looked even more closely at how we can optimally prepare the machine for retrofitting on smaller tankers with minimal mounting preparations.

The UP is delivered completely pre-assembled and can be easily mounted to any tanker and by any Bomech customer using universal Bomech mounting parts as a quick change system. Furthermore, the middle frame is designed in such a way that the trailing shoe can be mounted around any manhole (up to 1.20m diameter), so that the manhole remains freely accessible. The distributor is mounted very close to the tanker, whereby the centre of gravity is as close as possible to the slurry tanker and the support load is influenced as little as possible.

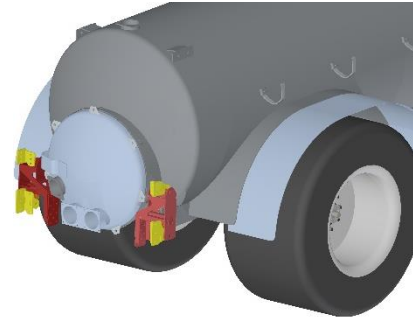

*Picture 3: various mounting possibilities*

### Folds compactly behind the tanker



*Picture 4: the UP folds compactly behind the tanker*

The difference with other Bomech trailing shoe distributors is that the UP, as the name suggests, folds vertically. The trailing shoe folds compactly behind the tanker, with an outer transport width of only 2.55m and a transport height of less than 3.50m for safe and secure road transport.

The side arms are locked and unlocked by means of a hydraulic transport lock, which is integrated in the middle frame. It will be automatically actuated by a safety circuit during unfolding.

### Flexible application possibilities

In the field, in the growing crops or on the grassland the new UP trailing shoe distributor is universal to use on different grounds, with always a very precise slurry application and the results you are used to from Bomech.



*Picture 5: the UP in working position*

## Bomech press release: UP

The active shoe pressure divides the plant stand and deposits the nutrients where they are needed, directly at the roots under the plants. In this way, the valuable manure is optimally used and absorbed for maximum yield and tasty silage.

As the outlets from the UP are folded up in the headland position, soiling from the headland will not occur.

### Standard very fully equipped including:

- Unique ground tracking system with the new developed Field Contour System (FCS) for perfect ground tracking
- Hydraulic cylinders with end cushioning
- High positioned Alrena macerator with stone / debris trap, for highest distribution accuracy
- LED-lightning kit
- 3 double active valves required
- Hydraulic transport locking
- Drop-Stop in headland position
- Impact protection left and right with breaking bolts from 7.5m

Optionally available with the following options: various mounting possibilities (quick-change, linkage, etc.), various control options as well as a 2DA sequence control or the electro-hydraulic I-Control, quick coupling for wide spreader and also there is a possibility to produce the UP in a dribble bar design.

### Technical info UP

Type	UP6	UP7.5	UP9	UP10.5
Working width (m)	6	7.5	9	10.5
Transport width (m)	2.55	2.55	2.55	2.55
Transport height (m)	2.50	3.20	3.25	3.25
Weight (kg)	530	560	660	700
Hose distance (cm)	25	25	25	25
No. of outlets	24	30	36	42

### Alternative Bomech retrofitting possibilities still available

The new UP is an addition to Bomech's already available retrofitting product range, so Bomech's trailing shoe distributors for retrofitting to existing tankers, such as the Flex (5.3 to 8.8m) and Speedy One (7.5 to 10.5m), still will be available for the future.